

Bi2 WALL

Ultra-slim high-wall terminal units



REVERSIBILITY

By rotating the display, Bi2 Wall can be installed as a split unit or a console machine.



FAMILY FEELING

Similar design as the Bi2 Air terminal to allow aesthetically coordinated installations in the same environment.



MULTISET CONTROL

Integrated electronics allows touch operation, remote control and home automation connection.



FEATURES

- Heats, Cools, Dehumidifies and Filters
- Brushless DC motor
- Equipped with large motorised flap
- Total flat aesthetics
- Compact: Thickness min. 12.9 cm max 15 cm.
- Range consisting of 3 models of different power.
- Fan coil unit supplied with 2 or 3-way valve integrated with 4 wire electrothermic actuators.
- Monobloc body for comfortable working.
- Motorised steel air delivery flap.
- Extractable filters placed on the air intake.
- Remote control supplied (only for TR control)
- Robust metal body
- Available in the colours: White RAL 9003

INTEGRATED CONTROLS AS STANDARD

TR (Touch Remote) CONTROL:

includes on-board touch control and a remote control (supplied). Additionally, through a combination of keys, it is possible to remotely* control with a B0736 wall remote control or a home automation control (SIOS Control by Olimpia Splendid or MyHome by Bticino), via the Modbus RS485 (ASCII or RTU) serial protocol. In addition through the user interface it is possible to add a correction on the read ambient temperature.

AR (Analog Remote) CONTROL:

allows remote control by interfacing with wall controls or home automation control systems via 0-10V analog input or contacts (for radiant fan coil units, use the contact mode). It has a 230Vac output for control of a solenoid valve and a water probe inlet with the function of a minimum probe (only for use in contact mode). **AR models on request.**

LAYOUT, DIMENSIONS, WEIGHT

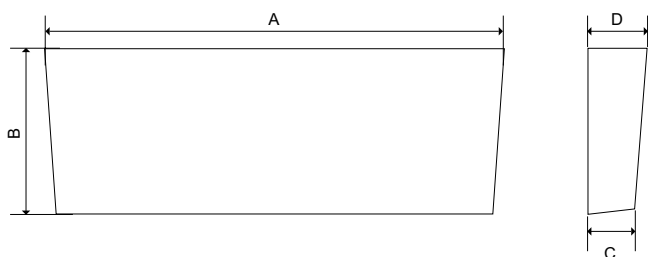

		400	600	800
A	mm	906	1106	1306
B	mm	380	380	380
C	mm	129	129	129
D	mm	150	150	150
Weight	kg	13	14.5	16

INSTALLATION

Console and high-wall.



* With the exception of the combination with SIOS Control, in all other cases: Touch control on the machine, air probe on the machine and remote control disabled

TECHNICAL DATA				400			600			800			
SLW inverter (with 2-way valve and TR command)				01784			01785			01786			
SLW inverter (with 2-way valve and AR command)				01875			01876			01877			
SLW inverter (with 3-way valve and TR command)				01787			01788			01789			
SLW inverter (with 3-way valve and AR command)				01878			01879			01880			
Fan speed				Lower	Middle	High	Lower	Middle	High	Lower	Middle	High	
Total power output in cooling mode	a27/19 - w7/12	(a)	(E)	kW	0.52	0.71	1.01	0.69	0.89	1.23	0.77	1.09	1.82
Sensitive power output in cooling mode	a27/19 - w7/12	(a)	(E)	kW	0.42	0.59	0.91	0.58	0.80	1.15	0.65	0.95	1.47
Fluid flow rate	a27/19 - w7/12	(a)		l/h	90.6	124.0	177.0	120.1	155.1	215.5	134.0	189.7	317.7
Water side head loss	a27/19 - w7/12	(a)	(E)	kPa	2.8	5.2	8.9	4.9	6	7.9	2.1	4.8	11
Total power output in heating mode	a20/15 - w50/-	(b)	(E)	kW	0.67	0.99	1.55	0.98	1.37	2.16	1.14	1.68	2.85
Fluid flow rate	a20/15 - w50/-	(b)		l/h	90.6	124.0	177.0	120.1	155.1	215.5	134.0	189.7	317.7
Water side head loss	a20/15 - w50/-	(b)	(E)	kPa	2.4	4.5	7.1	1.9	2.9	2.5	2.0	4.6	8.8
Total power output in heating mode	a20/15 - w45/40	(c)	(E)	kW	0.58	0.86	1.40	0.86	1.20	1.90	0.99	1.45	2.50
Fluid flow rate	a20/15 - w45/40	(c)		l/h	99.1	146.3	237.5	146.5	204.6	322.8	168.1	247.8	425.4
Water side head loss	a20/15 - w45/40	(c)	(E)	kPa	3.4	6.7	11.6	6.7	11.9	5.4	8.5	16.4	15.3
Absorbed power			(E)	W	7	11	19	8	12	23	9	13	27
Sound Power Lw (A)			(E)	dB(A)	43	49	57	43	50	58	43	50	58
Sound pressure Lp (A)			(d)	dB(A)	34	40	48	34	41	49	34	41	49
Air flow rate			(f)	m ³ /h	140	190	290	190	260	400	200	280	430
Battery water content				l		0.3			0.4			0.5	
Maximum operating pressure				bar		8			8			8	
Hydraulic fittings				inch		Eurocone 3/4			Eurocone 3/4			Eurocone 3/4	
Electrical power supply				V/ph/Hz		230/1/50			230/1/50			230/1/50	
Max static heating efficiency (50°C)				kW		-			-			-	
Max static heating efficiency (70°C)				kW		-			-			-	
Water content of the radiant panel				l		-			-			-	

The above services refer to the following operating conditions:

(a) Cooling mode at standard conditions: air temperature 27°C b.s. 19°C b.u., water inlet temperature 7°C, water outlet temperature 12°C

(b) Heating mode conditions of use 1: air temperature 20°C b.s., 15°C b.u. max, water inlet temperature 50°C, water flow equal to the cooling water standard condition

(c) Heating mode standard conditions: air temperature 20°C b.s., 15°C b.u. max, water inlet temperature 45°C, water outlet temperature 40°C

(d) Sound pressure level valid for closed rooms with a volume of 100 m³ with a reverberation time of 0.5 s and installation on the floor/ceiling, sound emission on 1/4 sphere at 3 m distance

(E) Eurovent certified data

(f) Air flow rate measured with clean filters

ACCESSORIES

SLW

CONTROLS	Code	Description	TR
	B0736	Wall-mounted Modbus chrono-thermostat kit	TR
	B0921	Contact touch wall-mounted thermostat kit	AR
	INDRZ	Addressing of the Modbus control kit	TR

Accessory description on page 92

Maximum installation versatility

Bi2 Wall is the first ultraslim hydronic fan coil that can be installed as a high wall "split" (High Wall configuration) or as a low wall console machine (Console configuration). Depending on the installation configuration, with a combination of keys on the control on the machine, the display digits are rotated.

In the High Wall configuration the water connections are positioned on the right and the display is positioned on the left.

In the Console configuration the water connections are positioned on the left and the display is positioned on the right.

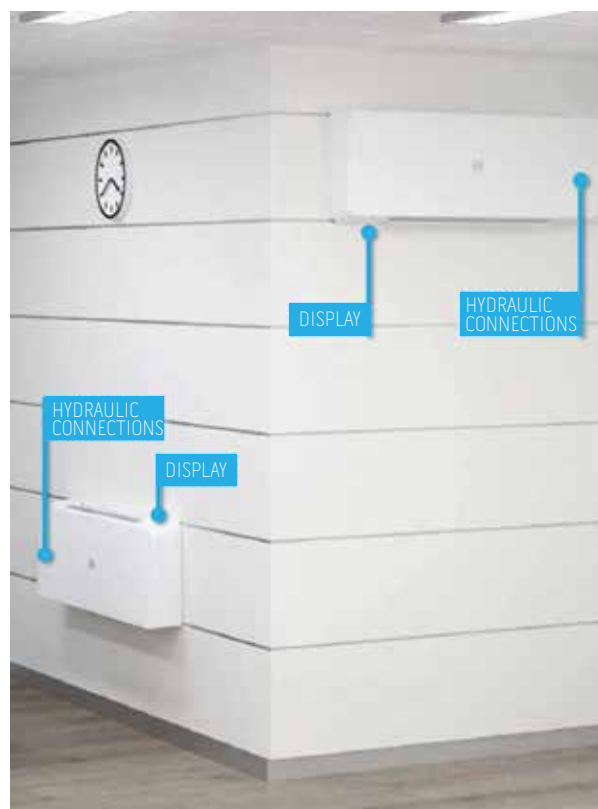

Please note that optional accessories are available for purchase in conjunction with all models of the terminal. When compatibility is only possible with certain sizes or models, the information is shown in the table.